

CONNECTION/INSTALLATION

❑ Connecting microphone for Bluetooth

Connect the microphone (9) to the MIC terminal.

- To install the microphone, peel off the adhesive tape, fix it on the installation position, then adjust the direction of the microphone to face the driver. After installing, fix the microphone cable to the car with clamps (commercially available).
- Clean the installation surface beforehand.

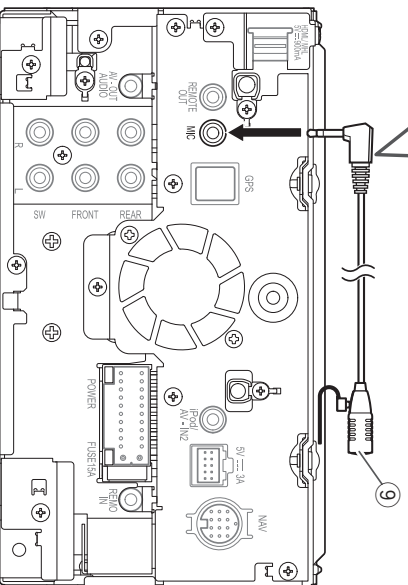
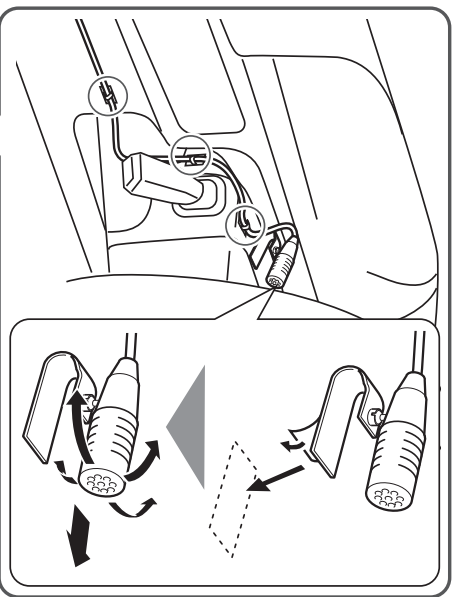

❑ Connecting the GPS antenna

Connect the GPS antenna (6) to the GPS terminal.

- To install the GPS antenna, fix the metal plate (7) firmly on the dashboard, then place the GPS antenna (6) on the metal plate (7).
- Clean the dashboard or other surface beforehand.
- Install the GPS antenna (6) inside of the car, as horizontally as possible to allow easy reception of the GPS satellite signals.
- You can bend the metal plate (7) to conform to a curved surface, if necessary.

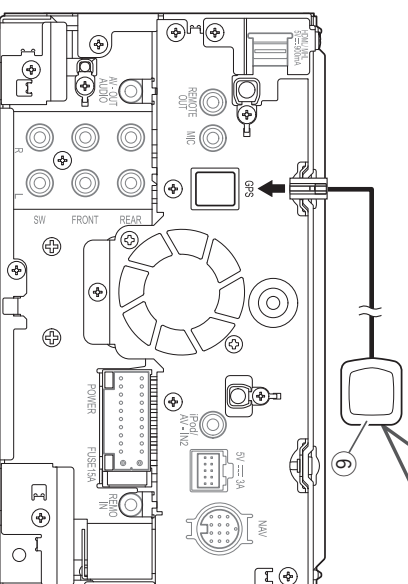
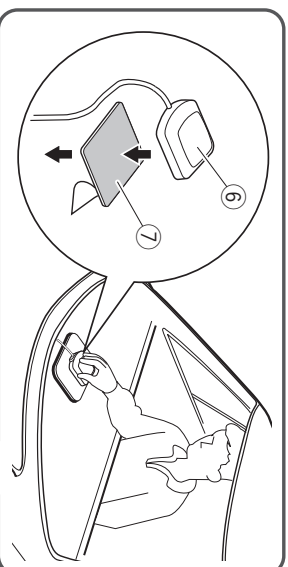

- Depending on the type of car, reception of the GPS satellite signals might not be possible with an internal installation.
- Install this GPS antenna in an area away from any antennas that are used with CB radios or satellite televisions.
- The GPS antenna should be installed at a position at least 30 cm from mobile phone or other transmitting antennas.
- The above types of communication may interfere with signals from the GPS satellite.
- Painting the GPS antenna with (metallic) paint may cause reduced performance.